



# INSTALLATION INSTRUCTIONS



Part Number: 34337

## Mortised Hardware

Read the legend below in order to easily follow along and install your hardware.

If needed, the hardware assembly is illustrated on the right.

### Tools Required

- Phillips screwdriver #2 
- Hex Key (provided) 

NOTE: handle style shown may vary by model, however, the installation steps will be the same.

### Handle Parts Illustration

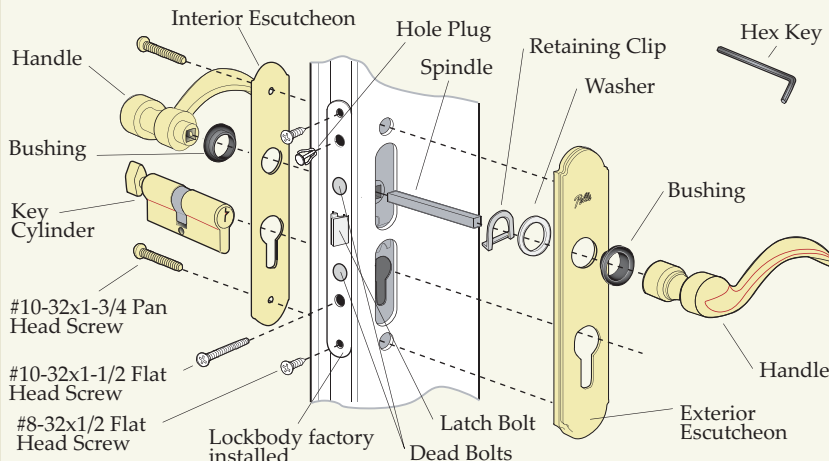

### Legend

- 1** • **2** • **3** ... Follow the steps in order, from 1 to 11.



Red objects are the action items for that step.

**MUST READ!** Instructions in the yellow boxes are **IMPORTANT!**

## START

Note: A right hinge installation is illustrated in each step.

- 1** Assemble: Exterior handle, black bushing, exterior escutcheon, and flat washer.

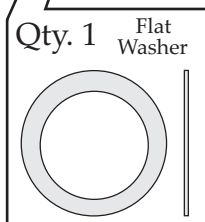
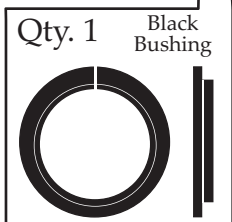
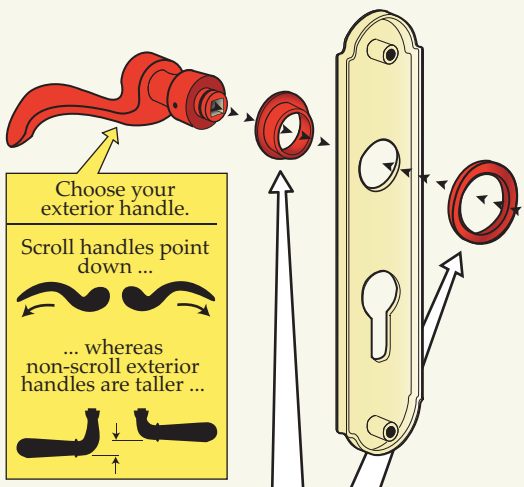

- 2** Secure with retaining clip.

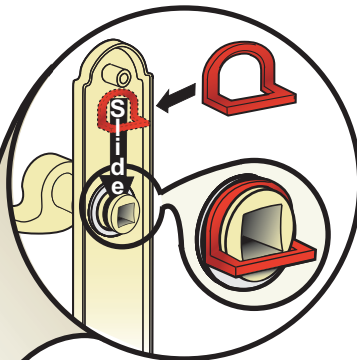

- 3** Insert spindle.

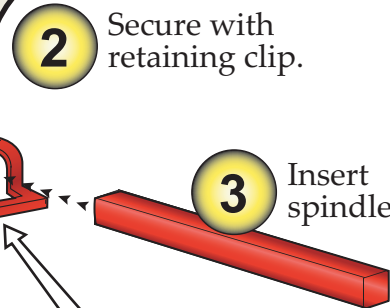

- 4** Tighten set screw.

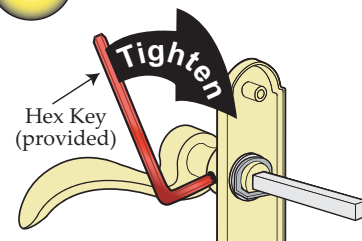

- 5** Lift up Lockbody. Insert key cylinder.

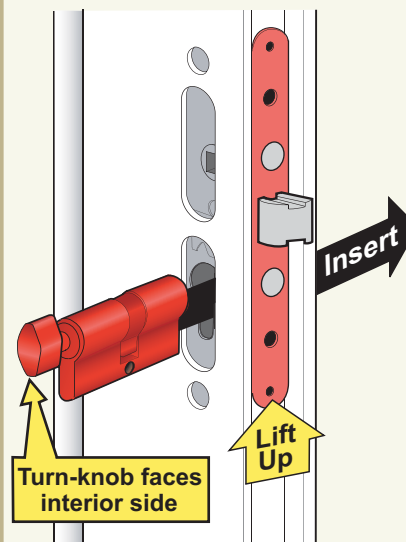

Continued on page 2

**6**

Loosely assemble: interior handle, black bushing, interior escutcheon, and exterior assembly.

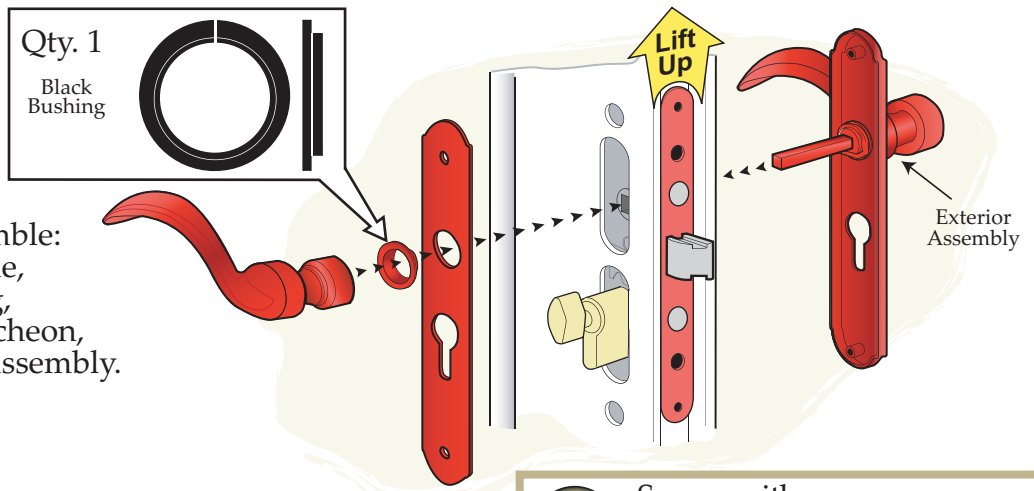

**7**

Secure with fasteners - in the following order.

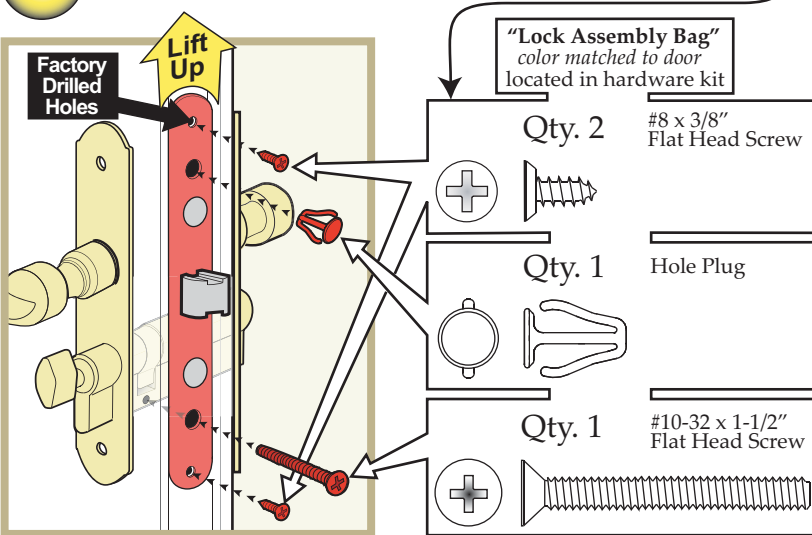

**8**

Secure with screws. Then, hold handles together and tighten interior set screw.

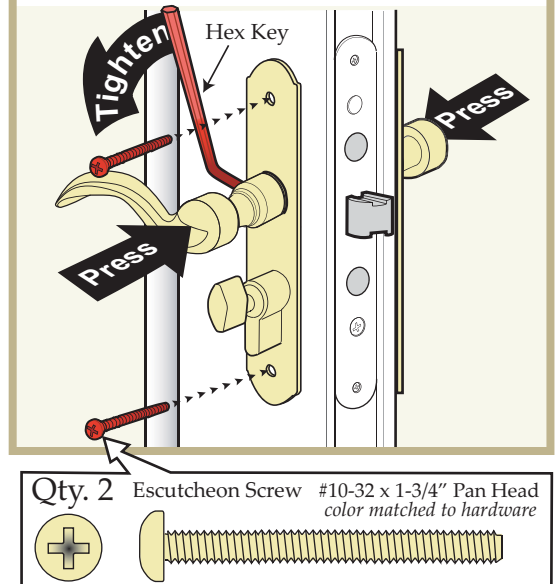

**9**

Remove and discard shipping plate and screws.

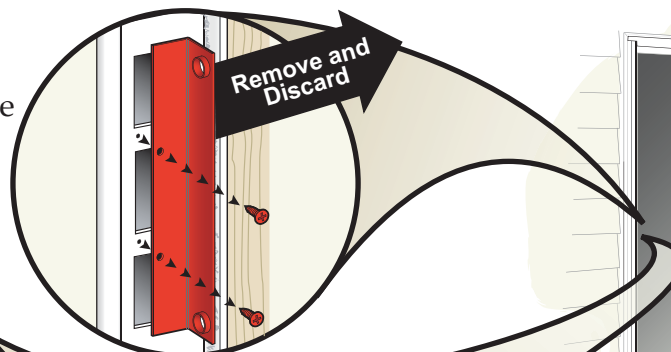

Adjust if Necessary

Use UPPER Factory Drilled Holes

**10**

Position trim plate using the UPPER holes.

**11**

Secure with screws. Adjust if necessary.

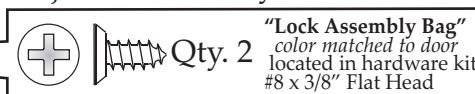

**Finished** with the hardware installation.  
Return to Page 8 of your "Owners Manual and Installation Guide" to complete the installation.